



## Importing Videos from Youtube into TechSmith Relay

### *Table of Contents*

*(click on the Highlander in the bottom right corner on any page to return here):*

- [Importing Videos from Youtube into TechSmith Relay](#)
- [Adding Quiz Questions to the Video](#)
- [Sharing the Video for Students to Watch \(Outside of D2L\)](#)
- [Who Watched the Video? Viewing Analytics \(Outside of D2L\)](#)
- [Using a TechSmith Relay Video \(Inside of D2L\)](#)



## Importing a Video from Youtube into TechSmith Relay

1. Log into your TechSmith Relay account at <https://gordonstate.techsmithrelay.com>
2. Choose “My Library” (top ribbon)
3. Choose “Create” (left side) and “Import from Youtube”
4. Input the URL for the Youtube video you would like to include
5. Given a few moments, the video should appear within your media area (My Library) of your TechSmith Relay account.

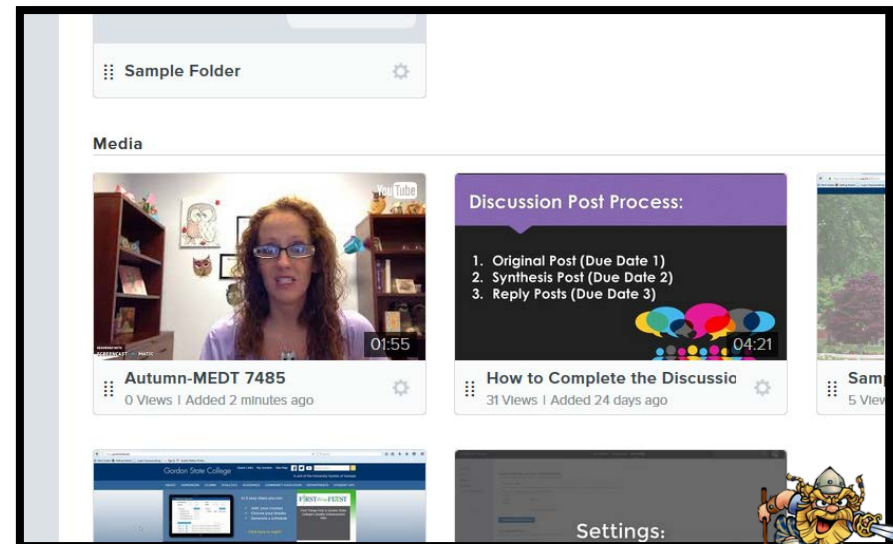
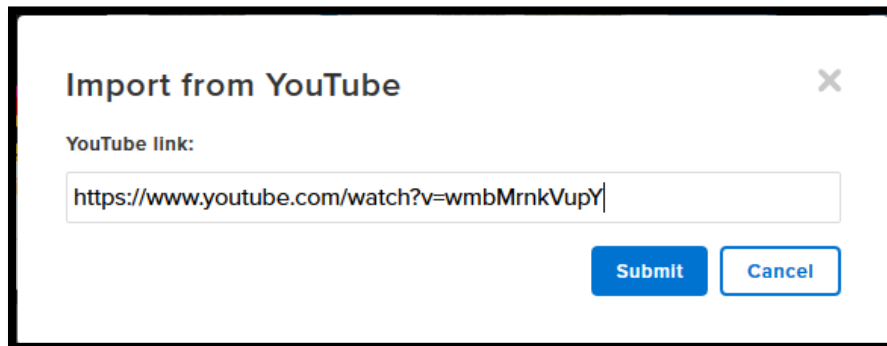
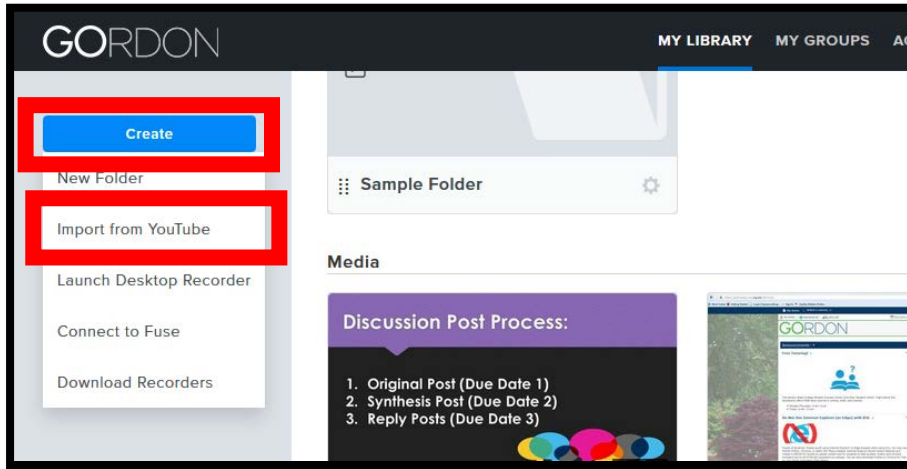

MY LIBRARY MY GROUPS ACTIVITY SITE ADMIN



Quizzing Analytics Reset Data Privacy

Share Delete Copy

### Autumn-MEDT 7485

By Autumn Schaffer | Created by YouTube user Autumn Schaffer | Added 3 minutes ago | 0 Views

Intro Video for MEDT 7485

Location: My Library

## Adding Quiz Questions to the Video

6. Select the video to add Quiz Questions (using the “**Quizzing**” tool). You can include graded/ungraded quizzes with multiple choice, true false, short answer, and fill in the blank questions.

Play the video to the point in which you want to add a quiz question, then choose “add a new question”.

### Edit Quizzing

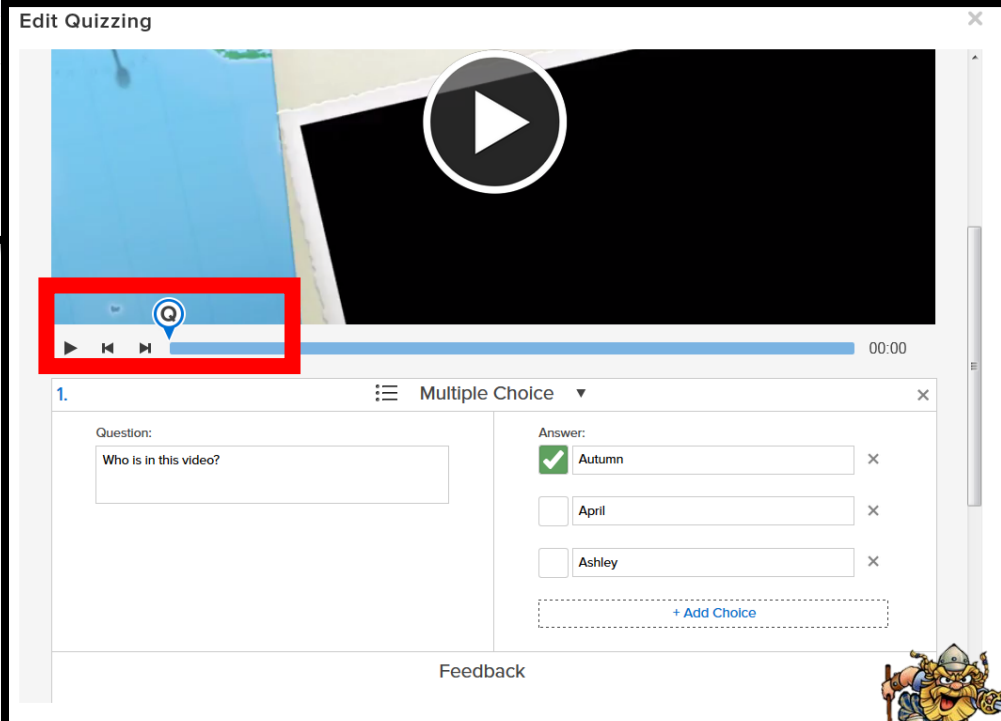

1. Multiple Choice

Question:  
Who is in this video?

Answer:  
 Autumn  
 April  
 Ashley  
[+ Add Choice](#)

Feedback



**Edit Quizzing**

Question: Who is in this video?

Answer:  Autumn  April  Ashley

[+ Add Choice](#)

**Feedback**

If correct: Great! It is Autumn!

Action: Continue

If incorrect: No, look again here...

Action: Jump to Time

Time (MMM:SS.000) 0 : 1 . 0

[+ Add New Question](#)

7. If the question has a correct answer, make sure to choose it when setting up the quiz.

Choose the feedback area to provide built-in responses based upon how the student answers. You can also choose an action (ie: If the student answers incorrectly, he/she is taken to a website with more information and/or he/she is taken back to a point within the video.)

8. Make sure to save the quiz in the top right corner in the quiz editor.

**Edit Quizzing**

Autumn-MEDT 7485

Autosaved draft at 6:11:59 PM [Discard Changes](#) [Save Quiz](#)



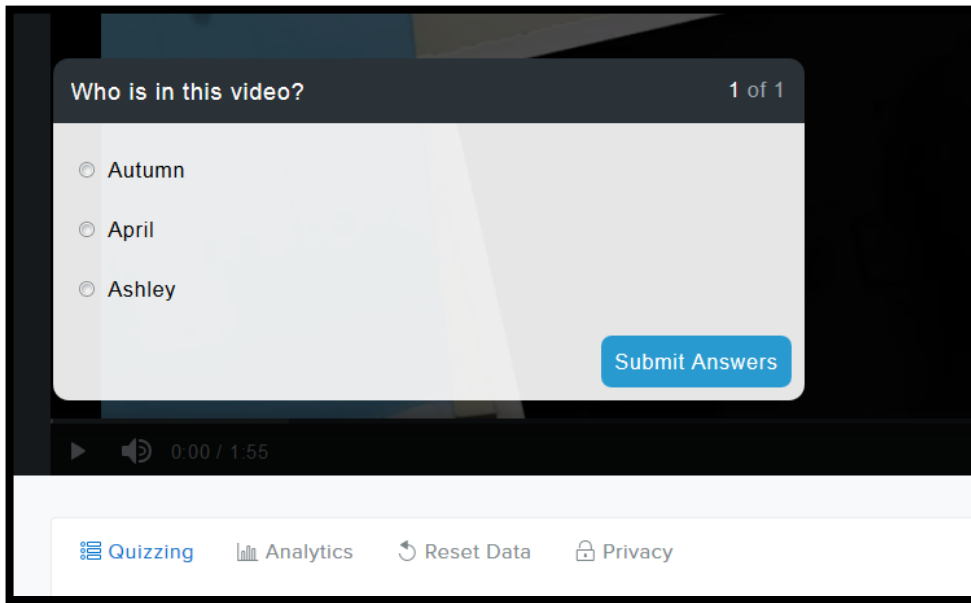

9. Once saved, the video will stop at the point of a question and display it. The video will not move forward until the student answers the question.

The feedback for the question (correct/incorrect) will appear after the student submits the answer to the question.

## Sharing the Video for Students to Watch (Outside of D2L)

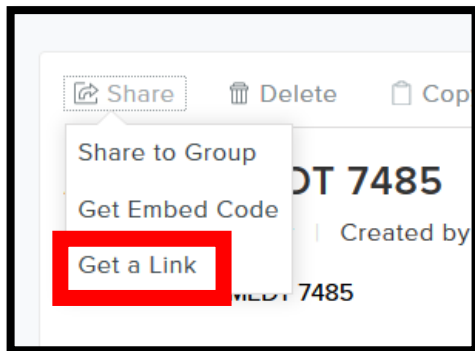

10. **You can share the video via a link to students, but if this link is distributed outside of D2L, students will have to login to their self-created TechSmith Relay account to be able to view it (this is so Relay can track who watched each video).**

In your “My Library” area, choose the video and “Share” and “Get a Link”. You can copy this link and place it in any file, webpage, email, etc. (again, students will have to log into their TechSmith account to view it.)



Quizzing Analytics Reset Data

**Autumn-MEDT 7485**  
Created:09/15/2017

View Results Edit Remove Quiz

Gordon State College Tour

Summary Viewer Questions

1. Smith Hall is the 2nd oldest building on-campus.

True 60% (6)  
False 40% (4)

Viewers	Answers
autumns@gordonstate.edu	True
autumns@gordonstate.edu	True
autumns@gordonstate.edu	False
kdavis@gordonstate.edu	True
kdavis@gordonstate.edu	True
autumn_m_schaffer@yahoo.com	True
EM144949@gordonstate.edu	True

11. To view the quiz results (outside of D2L), choose “**My Library**” and the video. Choose “**Quizzing**” and “**View Results**”. You will be able to see how users answered each question filtered by the user or by the question.

## Who Watched the Video? Viewing Analytics (Outside of D2L)

Quizzing Analytics Reset Data Privacy

Filter by Group :  
All Viewers

All	Partial	Completed
<b>Viewer</b>	<b>Completion</b>	
Ashley Example	4%	
Autumn Schaffer	4%	

Global Completion Rate  
out of 2 started viewers

12. From the “**My Library**” area, choose the video and “**Analytics**”. You will see a list of those who have viewed the video and what percentage of the video they watched.



Search Topics  🔍

Module 16 - Title Here ▾

Add dates and restrictions...

Add a description...

Upload / Create ▾ Existing Activities ▾ Bulk Edit

- Assignments
- Chat
- Checklist
- Discussions
- External Learning Tools
- Online Rooms
- Quizzes
- Self Assessments
- Surveys
- TechSmith Relay**

Table of Contents 141

START HERE:  
SYLLABUS COURSE  
DOC

Week 2 4  
Begins August 28

Instructor Hawkes 2

Information 6  
Literacy Modules

Weekly Live 1  
Meetings Here

M16 Introduc...

M16 Study G...

M16 Lecture...

M16 Discussi...

M16 Assignm...

How to Comple...

Add a sub-module...

## Using a TechSmith Relay Video (Inside of D2L)

13. If you use D2L, you can pull the video into your course and **students will NOT have to login to their TechSmith Relay account to view the video (logging into D2L will be sufficient)**. In the “**Content**” area of your course, choose the module on the far left side of the page. Choose “**Existing Activities**” and “**TechSmith Relay**”.

You will then be able to “**add media**” to include your video within D2L. The quizzing and analytics functions are still available within D2L.

Add Activity

← ▾

1 Media

Sample Folder

Media

Media	Date ▾	Title	Views
		<b>Autumn-MEDT 7485</b> Intro Video for MEDT 7485	3 Views   Added 30 minutes ago

**Add Media**

My Home > AwesomeAutumn Sam... ▾

Autumn Schaffer

RECORDED WITH SCREENCAST-O-MATIC

Quizzing Analytics Reset Data

**Autumn-MEDT 7485**

By Autumn Schaffer | Created by YouTube user Autumn Schaffer | Added 34 minutes ago | 3 Views

Intro Video for MEDT 7485

